

- GENERAL NOTS:**
1. ALL DIMENSION ARE IN MILIMETER.
 2. DESIGN STANDART EN40.
 3. DESIGN WILD SPEED 130 km/h.
 4. ALL CAST ALUM. ALLOY SHALL B 380,1 (Eihal-160).
 5. STEEL GRADE IS S235JR.
 6. ALL FASTENERS SHALL BE STAINLESS STEEL GR. 316 EQUIVALENT UNLEDD OTHER SPECIFIED.
 7. ALL WELDING SHALL BE DORE IN ACCORDANCE WIHT THE ANSI /BS EN ISO 9692-1-EQV-ALUMINUM .
 8. ALL WELDING SHALL BE DORE IN ACCORDANCE WIHT THE ANSI /BS EN ISO 9692-1-EQV-STEEL.
 9. SUPER DURABLE POWDER COATUNG BS.6496-1984 THICKNESS 100 MICRON (AVERAGE) AND 10 YEARS WARRANTY BS EN 12206-1:2000.
 10. STEEL REINFORCEMENT CORE-HOT DIP GALVANIZED.
 11. PIPE : BS EN 10219-1 -EQV
 12. ANCHOR BOLT & BASE PLATE: ASTM A572M GR. 345 OR EQUI.
 13. FINISHING: PAINTED / COATED (RAL# TO BE PROVIDED BY THE CUSTOMER)

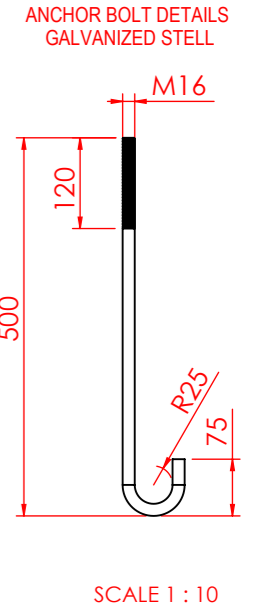

Proje Project	Tarih Date	Adı Soyadı Name Surname	İmza Sign	Malzeme Material	OptoLed Saving Energy						
Çizen / Desinger	07.07.2022	YUSUF SALİH									
Kontrol /Controller											
Parça Adı Part Name	H:6m POLE				Klasör Binder						
Ölçek Scale	Vida Anma Çapları Genel Tablosu The General Table For Screw Nominal Diameter				Dosya Adı File Name						
	Anma Çapı Nominal Diameter	1/2"	3/4"	1"	1 1/4"	1 1/2"	2"	Belirtilmeyen toleranslar Unspecified Tolerance			
								Aralık Inreval	0.5 ≤ 6	6 ≤ 30	30 ≤ 120
1/1 A3	Dişi - Internal	19.2 ⁰ _{-0.2}	24.7 ⁰ _{-0.2}	31 ⁰ _{-0.2}	39.6 ⁰ _{-0.2}	45.5 ⁰ _{-0.2}	57.3 ⁰ _{-0.2}	Hassas-Precision	±0.05	±0.1	±0.15
	Erkek -External	20.7 ^{+0.1} ₀	26.2 ^{+0.1} ₀	32.9 ^{+0.1} ₀	41.6 ^{+0.1} ₀	47.5 ^{+0.1} ₀	59.3 ^{+0.1} ₀	Orta- Moderate	±0.1	±0.2	±0.3
											Resim No Picture No
											Revizyon No Revision No