

# OptoLed

Saving Energy

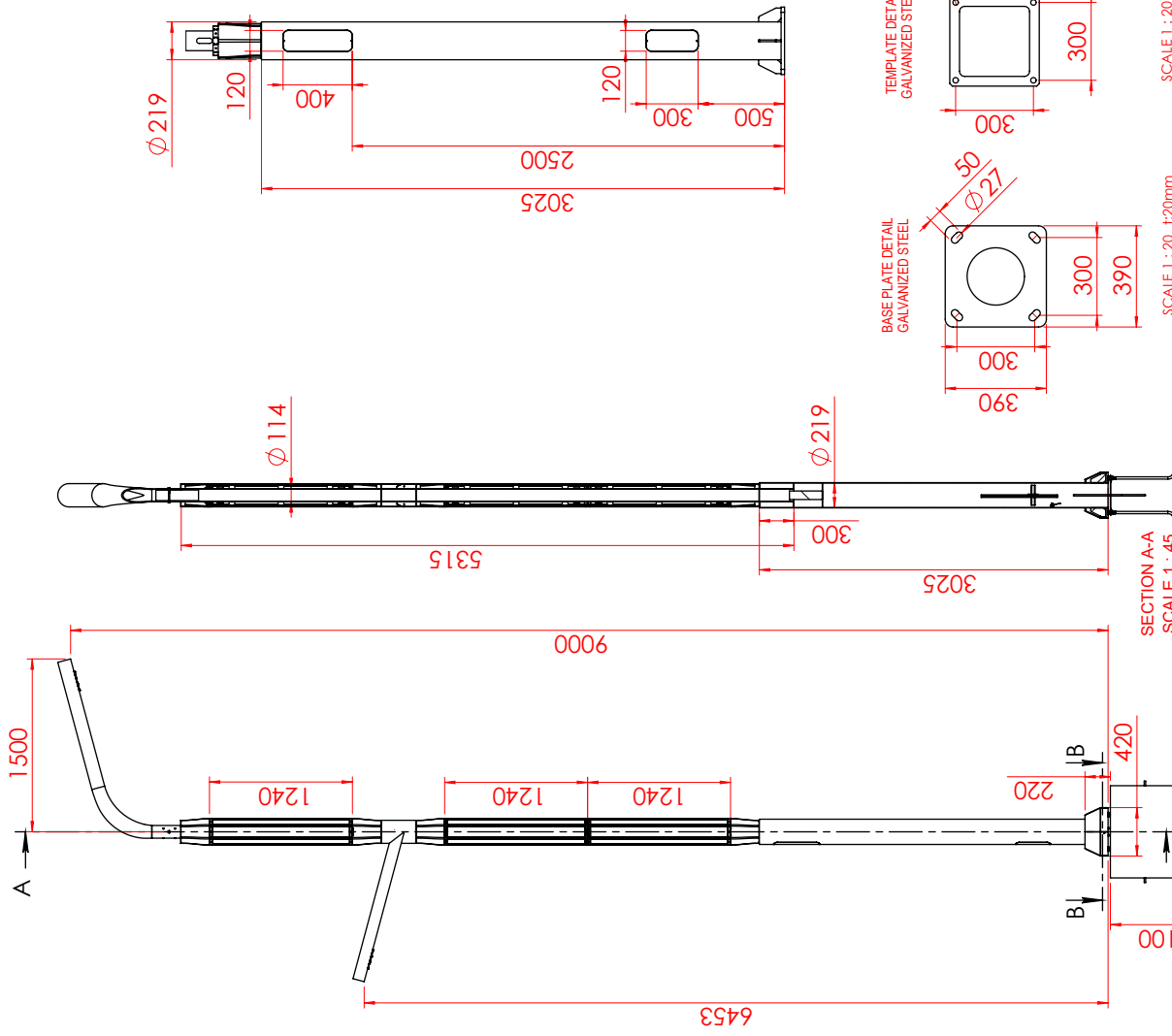

- GENERAL NOTES:**
- ALL DIMENSIONS ARE IN MILLIMETER.
  - DESIGN STANDARD EN40.
  - DESIGN WELD SPEED 16.0 km/h.
  - ALL CAST ALUM. ALLOY SHALL B 380.1 (ENP1140).
  - ALL FASTENERS SHALL BE STAINLESS STEEL GR. 316.
  - ALL WELDING SHALL BE DORE IN ACCORDANCE WITH THE ANS/BS EN ISO 9692-1-EDV-ALUMINIUM.
  - ALL WELDING SHALL BE DORE IN ACCORDANCE WITH THE ANS/BS EN ISO 9692-1-EDV-STEEL.
  - SUPER DURABLE POWDER COATING THICKNESS 100 MICRON (AVERAGE) BS EN 12206-1:2000.
  - STEEL REINFORCEMENT CORE-HOT DIP GALVANIZED.
  - PIPE : BS EN 10219-1 -EQV
  - ANCHOR BOLT & BASE PLATE ASTM A572M GR. 345 OR EQUI.
  - FINISHING: PAINTED / COATED (RAL 7024)

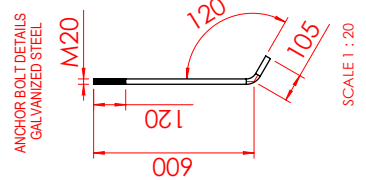
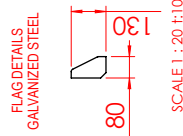

SECTION A-A SCALE 1 : 45

SCALE 1 : 20 1:20mm

SCALE 1 : 20 1:2mm

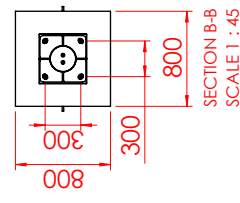
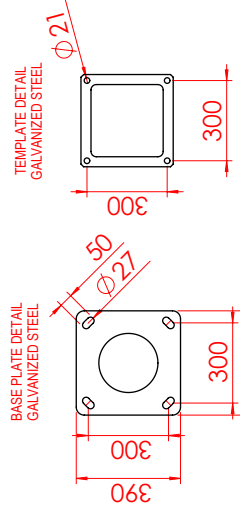
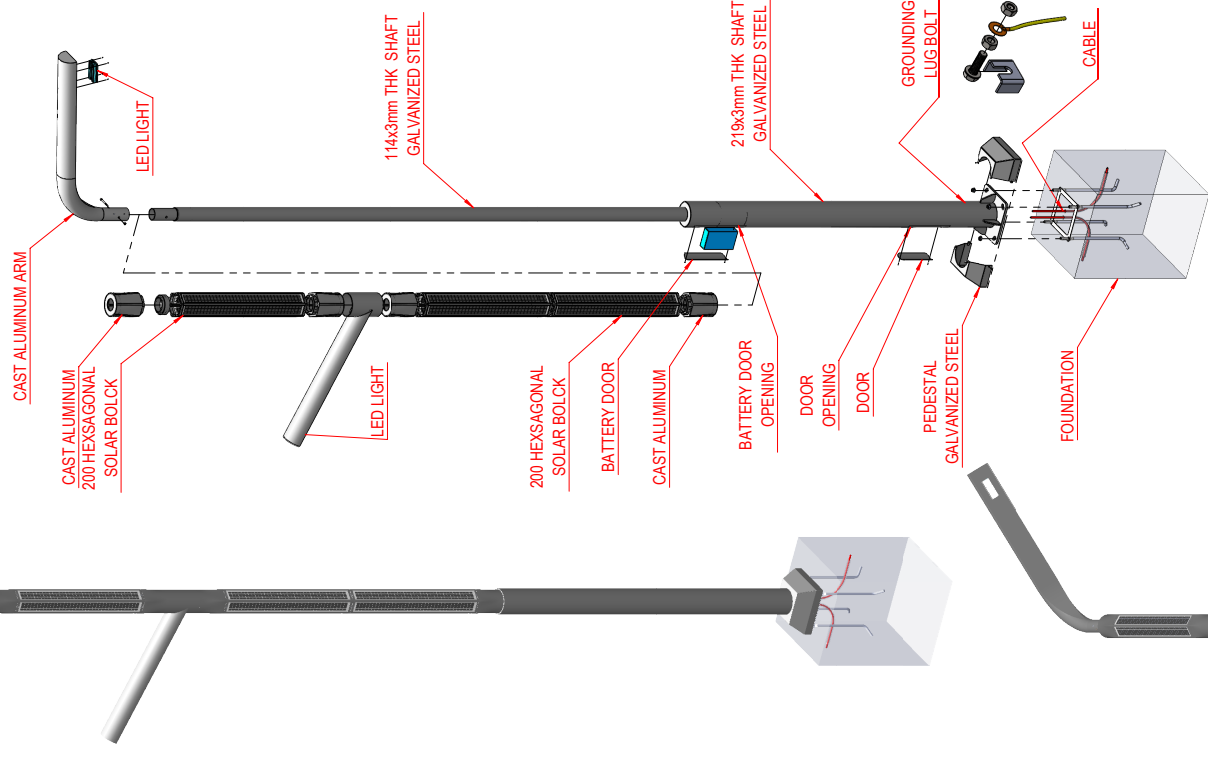

Proje Project	Çizim / Desinger	Tarih Date	Adı Soyadı Name Surname	İmza Sign	Malzeme Material	Klasör Binder		PROJ.NO:2506014		
						Parça Adı Part Name		H-9mSOLAR PATHWAY DOUBLE POLE		
Ölçek Scale	1/1 A3	Vida Anma Çapları Genel Tablosu The General Table for Screw Nominal Diameter				Belirlenmeyen toleranslar Unspecified Tolerances	Dosya Adı File Name	BMTC PROJECT		
		Anma Çapı Nominal Diameter	1/2"	3/4"	1"		1 1/4"	1 1/2"	2"	Resim No Picture No
		Diş - Internal	19.2 <sup>+0.2</sup>	24.7 <sup>+0.2</sup>	31.8 <sup>+0.2</sup>	39.6 <sup>+0.2</sup>	45.5 <sup>+0.2</sup>	57.3 <sup>+0.2</sup>	Revizyon No Revision No	1/2
		Ertek - External	20.7 <sup>+0.1</sup>	26.2 <sup>+0.1</sup>	32.9 <sup>+0.1</sup>	41.6 <sup>+0.1</sup>	47.5 <sup>+0.1</sup>	59.3 <sup>+0.1</sup>	Revizyon No Revision No	



GENERAL NOTES:

1. ALL DIMENSIONS ARE IN MILLIMETER.
2. DESIGN STANDARD EN40.
3. DESIGN WIND SPEED 16.0 km/h.
4. ALL CAST ALUM. ALLOY SHALL B 380.1 (BIRH-160).
5. ALL FASTENERS SHALL BE STAINLESS STEEL GR. 316 EQUIVALENT UNLESS OTHERWISE SPECIFIED.
6. ALL WELDING SHALL BE DONE IN ACCORDANCE WITH THE ANSI/BS EN ISO 9872-1-EGV-ALUMINIUM.
7. ALL WELDING SHALL BE DONE IN ACCORDANCE WITH THE ANSI/BS EN ISO 9872-1-EGV-STEEL.
8. SUPER DURABLE POWDER COATING BS 4446-1-PM THICKNESS 100 MICRON (AVERAGE) BS EN 12204-1:2000.
9. STEEL REINFORCEMENT CORE-HOT DIP GALVANIZED.
10. PIPE: BS EN 10219-1-EGV
11. ANCHOR BOLT & BASE PLATE: ASTM A572M GR. 345 OR EQUI.
12. FINISHING: PAINTED / COATED (PAL # TO BE PROVIDED BY THE CUSTOMER)

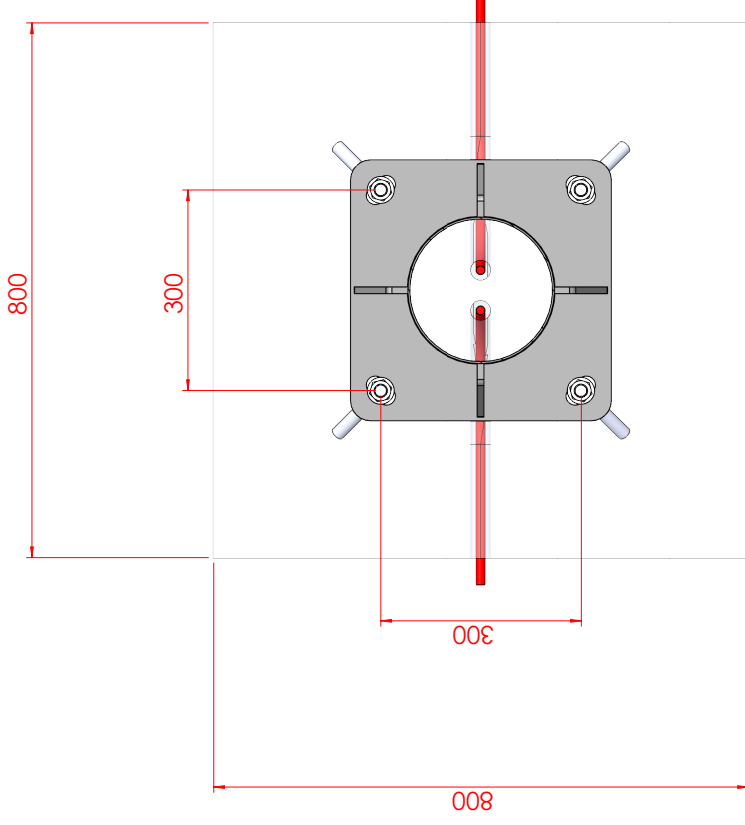

SECTION H-H  
SCALE 1 : 8

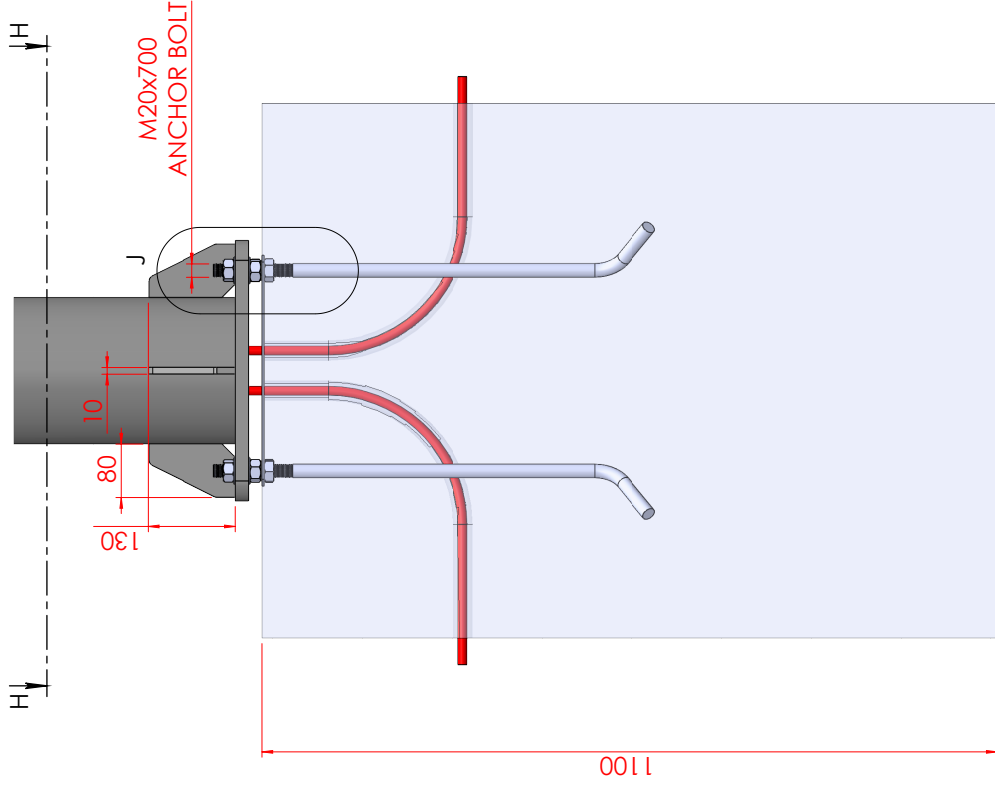

DETAIL J  
SCALE 1 : 4

<b>Proje</b> Project	<b>Tarih</b> Date	<b>Adı Soyadı</b> Name Surname	<b>İmza</b> Sign	<b>Malzeme</b> Material	<b>Klasör</b> Binder	PROJ.NO:2506014	
<b>Çizen / Desinger</b> Control /Controller	06.08.2025	YUSUF SALİH			<b>Dosya Adı</b> File Name	BMTC PROJECT	
<b>Parça Adı</b> Part Name	H:9m SOLAR SINGLE POLE				<b>Resim No</b> Picture No	2/2	
<b>Ölçek</b> Scale	<b>Vida Anma Çapları Genel Tablosu</b> The General Table For Screw Nominal Diameter			<b>Belirlenmeyen Toleranslar</b> Unspecified Tolerances	<b>Revizyon No</b>		
1 / 1	<b>Arama Çapı</b> Nominal Diameter	1/2"	3/4"	1"	1 1/4"	1 1/2"	2"
	<b>Dişi - Internal</b>	19.2 <sup>+0.2</sup>	24.7 <sup>+0.2</sup>	31.3 <sup>+0.2</sup>	39.6 <sup>+0.2</sup>	45.5 <sup>+0.2</sup>	57.3 <sup>+0.2</sup>
		±0.05	±0.05	±0.1	±0.15	±0.1	±0.15

**OptoLed**  
Saving Energy