

BASE PLATE DETAIL ALUMINUM

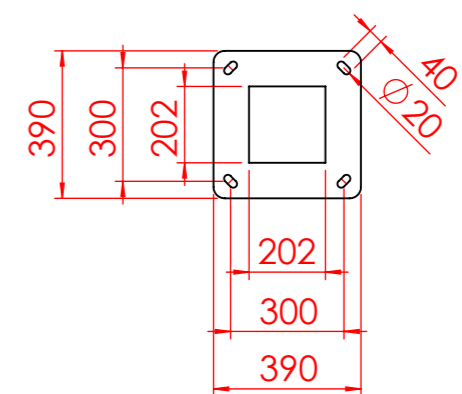

SCALE 1 : 20 t:10mm

FLAG DETAILS ALUMINUM

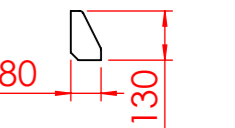

SCALE 1 : 20 t:6mm

ANCHOR BOLT DETAILS GALVANIZED STEEL

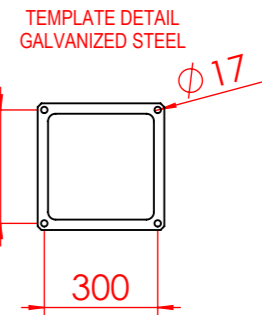

SCALE 1 : 20 t:2mm

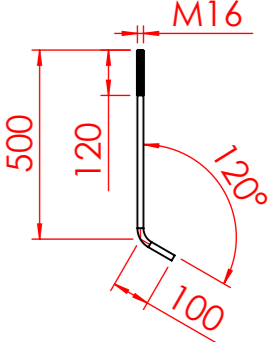

SCALE 1 : 20

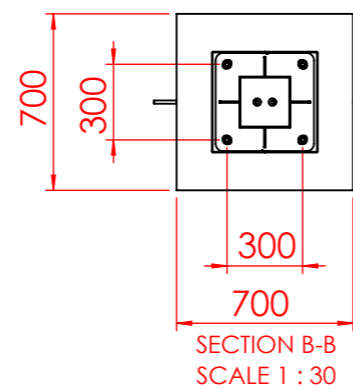

Proje Project	Tarih Date	Adı Soyadı Name Surname	İmza Sign	Malzeme Material																																												
Çizen / Desinger	11.08.2023	YUSUF SALİH																																														
Kontrol /Controller																																																
Parça Adı Part Name	H:5m SEGA SINGLE POLE				Klasör Binder																																											
Ölçek Scale	Vida Anma Çapları Genel Tablosu The General Table For Screw Nominal Diameter				Dosya Adı File Name																																											
1/1 A3	<table border="1"> <thead> <tr> <th>Anma Çapı Nominal Diameter</th> <th>1/2"</th> <th>3/4"</th> <th>1"</th> <th>1 1/4"</th> <th>1 1/2"</th> <th>2"</th> <th colspan="3">Belirtilmeyen toleranslar Unspecified Tolerance</th> </tr> <tr> <th>Dişi - Internal</th> <td>19.2⁰_{-0.2}</td> <td>24.7⁰_{-0.2}</td> <td>31.0⁰_{-0.2}</td> <td>39.6⁰_{-0.2}</td> <td>45.5⁰_{-0.2}</td> <td>57.3⁰_{-0.2}</td> <th>Aralık Inreval</th> <td>0.5 ≤ 6</td> <td>6 ≤ 30</td> <td>30 ≤ 120</td> </tr> <tr> <th>Erkek -External</th> <td>20.7^{+0.1}₀</td> <td>26.2^{+0.1}₀</td> <td>32.9^{+0.1}₀</td> <td>41.6^{+0.1}₀</td> <td>47.5^{+0.1}₀</td> <td>59.3^{+0.1}₀</td> <th>Hassas-Precision</th> <td>±0.05</td> <td>±0.1</td> <td>±0.15</td> </tr> <tr> <th></th> <td></td> <td></td> <td></td> <td></td> <td></td> <td></td> <th>Orta-Moderate</th> <td>±0.1</td> <td>±0.2</td> <td>±0.3</td> </tr> </thead> </table>				Anma Çapı Nominal Diameter	1/2"	3/4"	1"	1 1/4"	1 1/2"	2"	Belirtilmeyen toleranslar Unspecified Tolerance			Dişi - Internal	19.2 ⁰ _{-0.2}	24.7 ⁰ _{-0.2}	31.0 ⁰ _{-0.2}	39.6 ⁰ _{-0.2}	45.5 ⁰ _{-0.2}	57.3 ⁰ _{-0.2}	Aralık Inreval	0.5 ≤ 6	6 ≤ 30	30 ≤ 120	Erkek -External	20.7 ^{+0.1} ₀	26.2 ^{+0.1} ₀	32.9 ^{+0.1} ₀	41.6 ^{+0.1} ₀	47.5 ^{+0.1} ₀	59.3 ^{+0.1} ₀	Hassas-Precision	±0.05	±0.1	±0.15								Orta-Moderate	±0.1	±0.2	±0.3	Revizyon No Revision No
Anma Çapı Nominal Diameter	1/2"	3/4"	1"	1 1/4"	1 1/2"	2"	Belirtilmeyen toleranslar Unspecified Tolerance																																									
Dişi - Internal	19.2 ⁰ _{-0.2}	24.7 ⁰ _{-0.2}	31.0 ⁰ _{-0.2}	39.6 ⁰ _{-0.2}	45.5 ⁰ _{-0.2}	57.3 ⁰ _{-0.2}	Aralık Inreval	0.5 ≤ 6	6 ≤ 30	30 ≤ 120																																						
Erkek -External	20.7 ^{+0.1} ₀	26.2 ^{+0.1} ₀	32.9 ^{+0.1} ₀	41.6 ^{+0.1} ₀	47.5 ^{+0.1} ₀	59.3 ^{+0.1} ₀	Hassas-Precision	±0.05	±0.1	±0.15																																						
							Orta-Moderate	±0.1	±0.2	±0.3																																						
					PROJ.NO:2307017																																											
					WATERFRONT DEVELOPMENT PROJECT																																											
					1/2																																											

GENERAL NOTS:

- ALL DIMENSION ARE IN MILIMETER.
- DESIGN STANDART EN40.
- DESIGN WILD SPEED 130 km/h.
- ALL CAST ALUM. ALLOY SHALL B 380,1 (E101-160).
- ALL FASTENERS SHALL BE STAINLESS STEEL GR. 316 EQUIVALENT UNLEDD OTHER SPECIFIED.
- ALL WELDING SHALL BE DORE IN ACCORDANCE WIHT THE ANSI /BS EN ISO 9692-1-EQV-ALUMINUM .
- ALL WELDING SHALL BE DORE IN ACCORDANCE WIHT THE ANSI /BS EN ISO 9692-1-EQV-STEEL.
- SUPER DURABLE POWDER COATUNG BS.6496-1984 THICKNESS 100 MICRON (AVERAGE) BS EN 12206-1:2000.
- STEEL REINFORCEMENT CORE-HOT DIP GALVANIZED.
- PIPE : BS EN 10219-1 -EQV
- ANCHOR BOLT & BASE PLATE: ASTM A572M GR. 345 OR EQUI.
- FINISHING: PAINTED / COATED (RAL 7024)

GENERAL NOTS:

1. ALL DIMENSION ARE IN MILIMETER.
2. DESIGN STANDART AASHTO.
3. DESIGN WILD SPEED 160 km/h.
4. ALL CAST ALUM. ALLOY SHALL B 380,1 (Efilal-160).
5. ALL FASTENERS SHALL BE STAINLESS STEEL GR. 316 EQUIVALENT UNLEDD OTHER SPECIFIED.
6. ALL WELDING SHALL BE DORE IN ACCORDANCE WIHT THE ANSI /BS EN ISO 9692-1- EQV-ALUMINUM .
7. ALL WELDING SHALL BE DORE IN ACCORDANCE WIHT THE ANSI /BS EN ISO 9692-1- EQV-STEEL.
8. SUPER DURABLE POWDER COATUNG BS.6496-1984 THICKNESS 100 MICRON (AVENAGE) BS EN 12206-1:2000.
9. STEEL REINFORCEMENT CORE-HOT DIP GALVANIZED.
10. PIPE : BS EN 10219-1 -EQV
11. ANCHOR BOLT & BASE PLATE: ASTM A572M GR. 345 OR EQUI.
12. FINISHING: PAINTED / COATED (RAL # TO BE PROVIDED BY THE CUSTOMER)

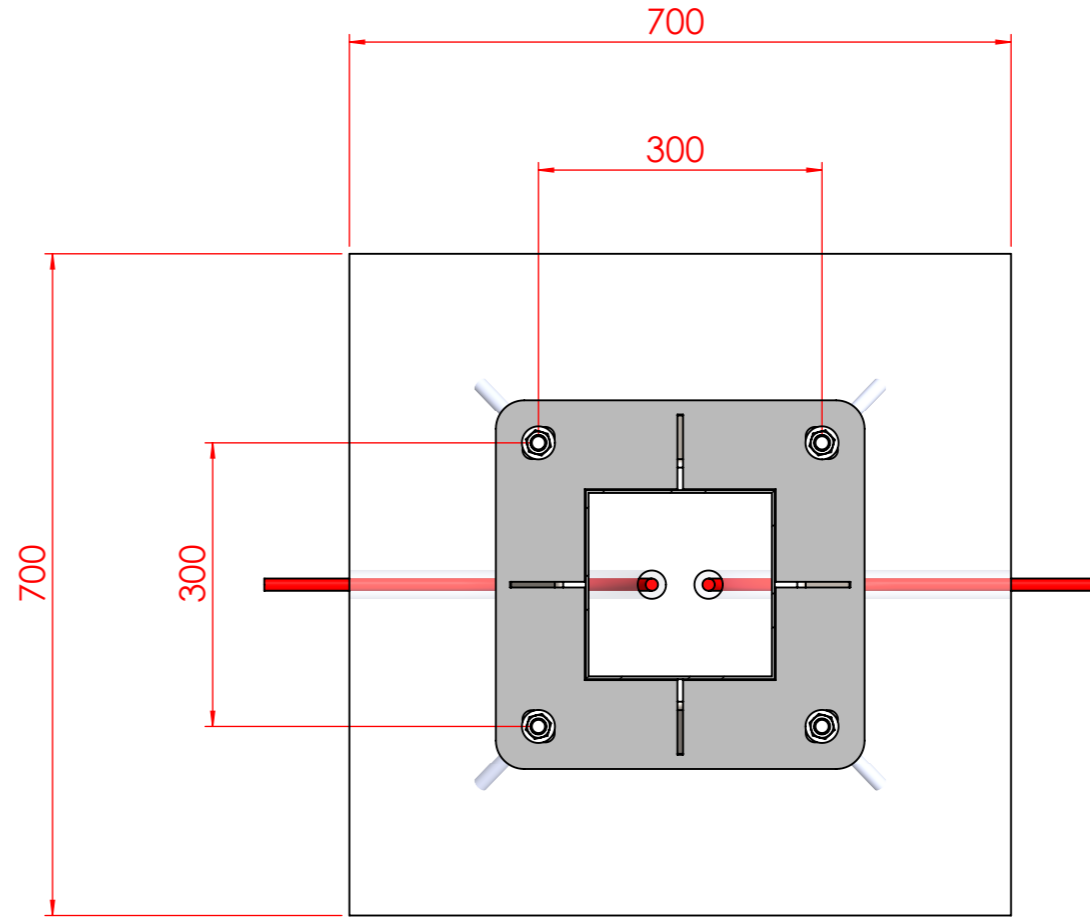
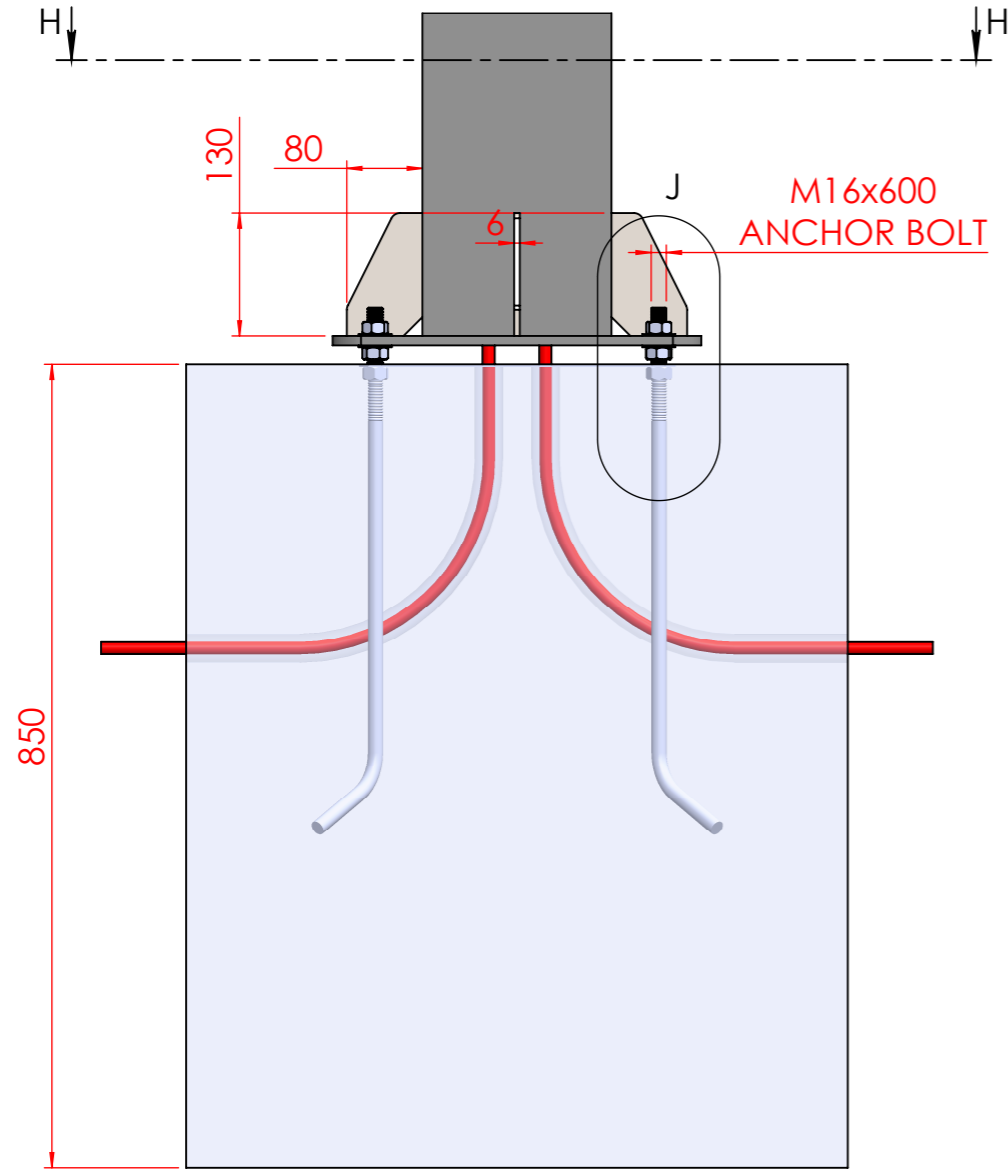
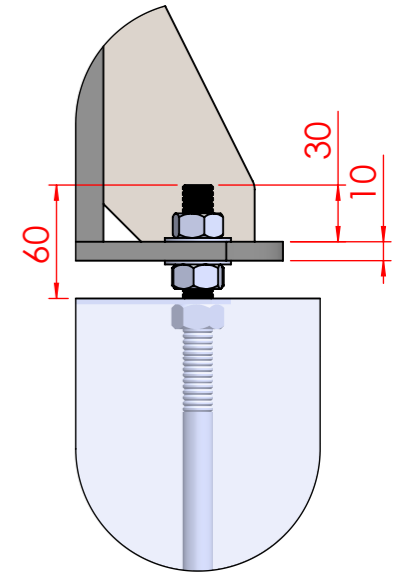
SECTION H-H
SCALE 1 : 8DETAIL J
SCALE 1 : 4

Proje <i>Project</i>	Tarih <i>Date</i>	Adı Soyadı <i>Name Surname</i>	İmza <i>Sign</i>	Malzeme <i>Material</i>	OptoLed Saving Energy								
Çizen / Desinger	11.08.2023	YUSUF SALİH											
Kontrol /Controller													
Parça Adı <i>Part Name</i>	H:5m SEGA SINGLE POLE				Klasör <i>Binder</i>	PROJ.NO:2307017							
Ölçek <i>Scale</i>	Vida Anma Çapları Genel Tablosu <i>The General Table For Screw Nominal Diameter</i>				Dosya Adı <i>File Name</i>	WATERFRONT DEVELOPMENT PROJECT							
1/1 A3	Anma Çapı <i>Nominal Diameter</i>	1/2"	3/4"	1"	1 1/4"	1 1/2"	2"	Aralık <i>Inreval</i>	0.5 ≤ 6	6 ≤ 30	30 ≤ 120	Resim No <i>Picture No</i>	2/2
	Dişi - Internal	19.2 ⁰ _{-0.2}	24.7 ⁰ _{-0.2}	31 ⁰ _{-0.2}	39.6 ⁰ _{-0.2}	45.5 ⁰ _{-0.2}	57.3 ⁰ _{-0.2}	Hassas-Precision	±0.05	±0.1	±0.15	Revizyon No <i>Revision No</i>	
	Erkek -External	20.7 ^{+0.1} ₀	26.2 ^{+0.1} ₀	32.9 ^{+0.1} ₀	41.6 ^{+0.1} ₀	47.5 ^{+0.1} ₀	59.3 ^{+0.1} ₀	Orta- Moderate	±0.1	±0.2	±0.3		